

COMMANDS:

PINH (ϕ) 1-3~~2~~
DROPP
HOLD (TIME)

(F ϕ) CURRENT
(F) PULLS-UP TO EXISTIN SLOT
(D)
(H) (H-FOR GIVEN) (H-SEMPOTIME)

{ SMIDI (CM) LIGHT PARAMETERS

~~PULLUP (P)~~

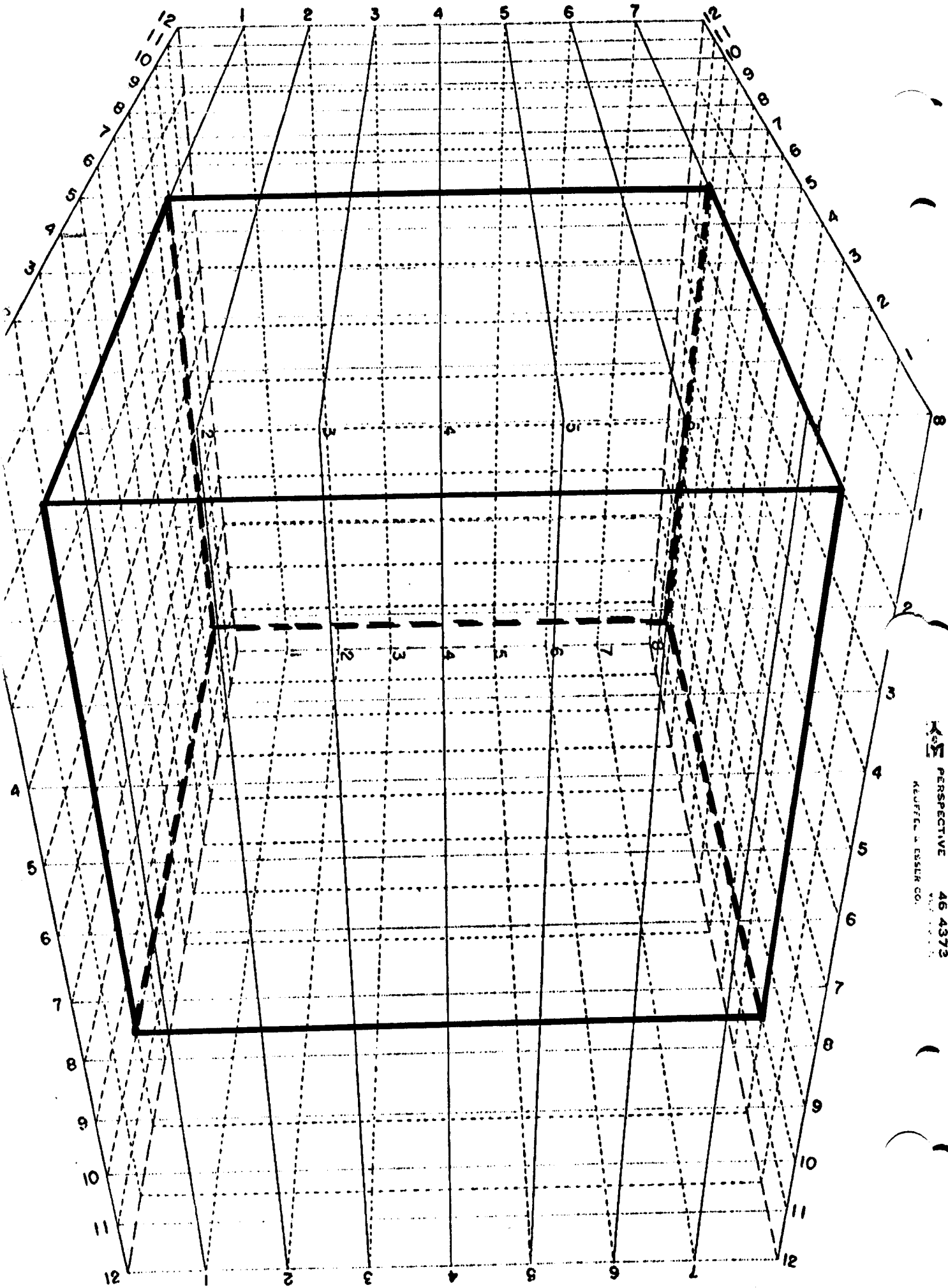

PERSPECTIVE 46 4372
 KEUFFEL & ESSER CO.

Vasulka

plan
scale : 1/50°

.....
cables - ceiling structure
black patina (yellow)

▭
element of handrail
wood

▨
platform 0.17 m

Artifices 2

scaler philippe edite

14 / 13 rue hildoy
93103 montfermeil
tel : 46 70 17 85
fax : 46 70 16 74

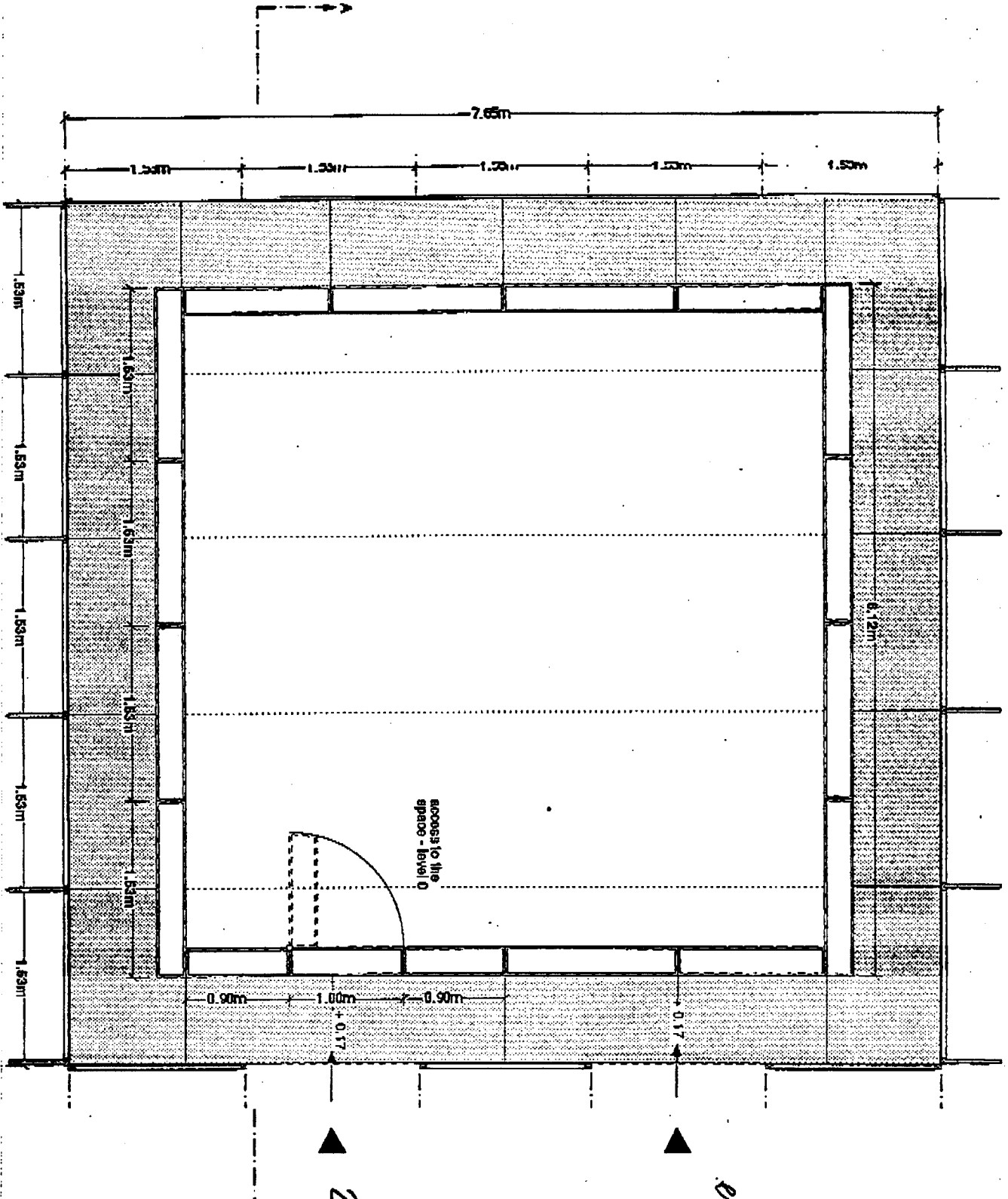

$A=7$ $E=2$ $f=2$
 $B=7$ $F=1$ $R=4$
 $C=6$ $G=1$ $R=1$
 $H=1$ $H=1$ $H=1$

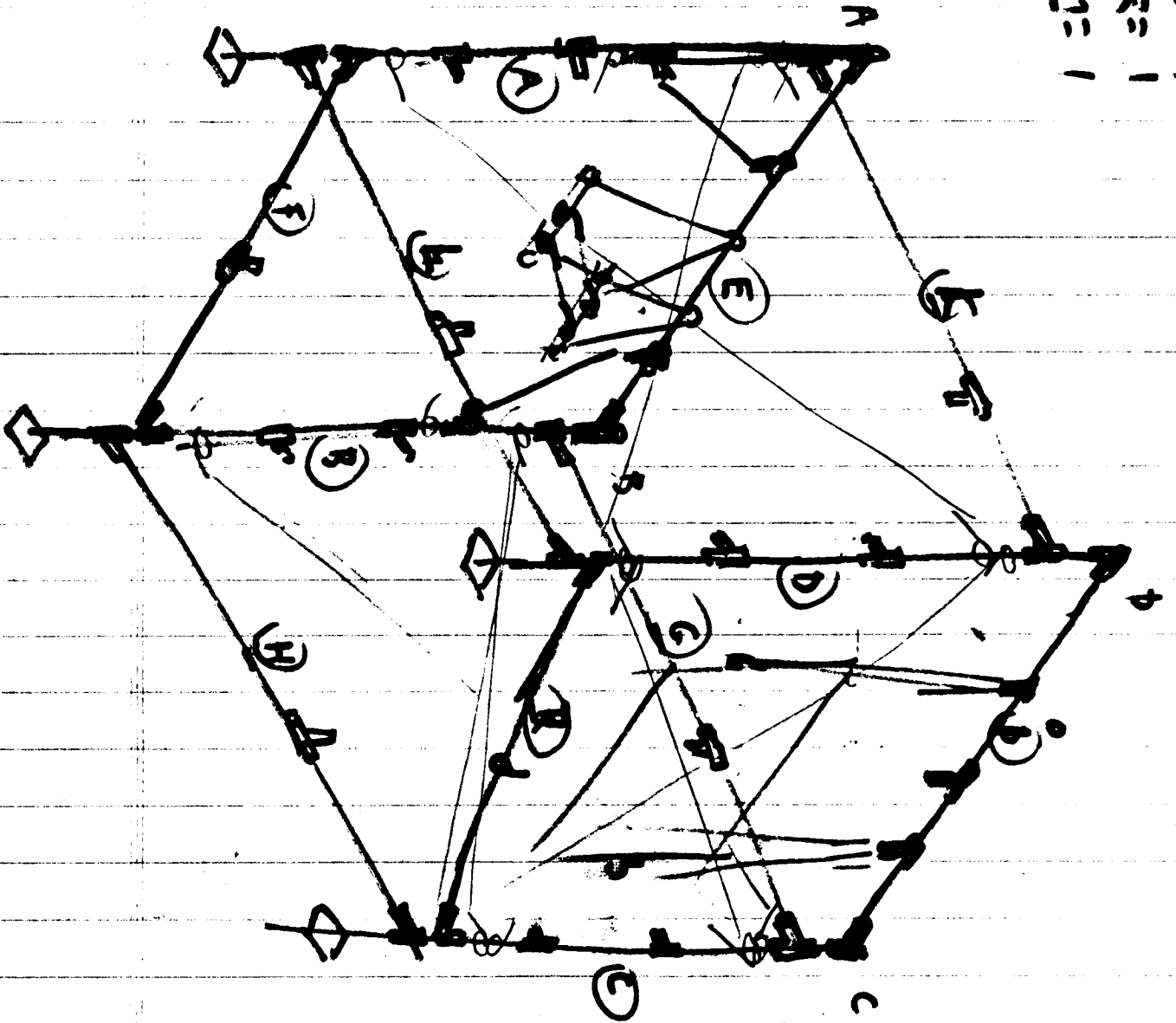

1987
 1987

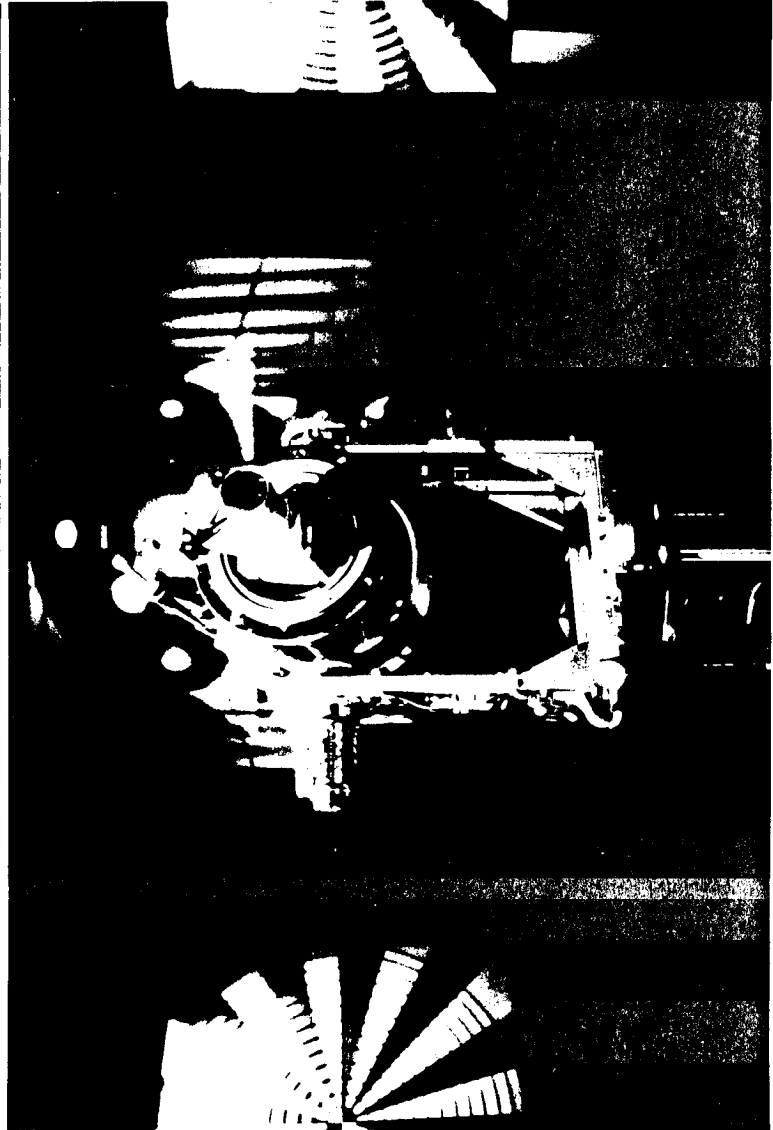
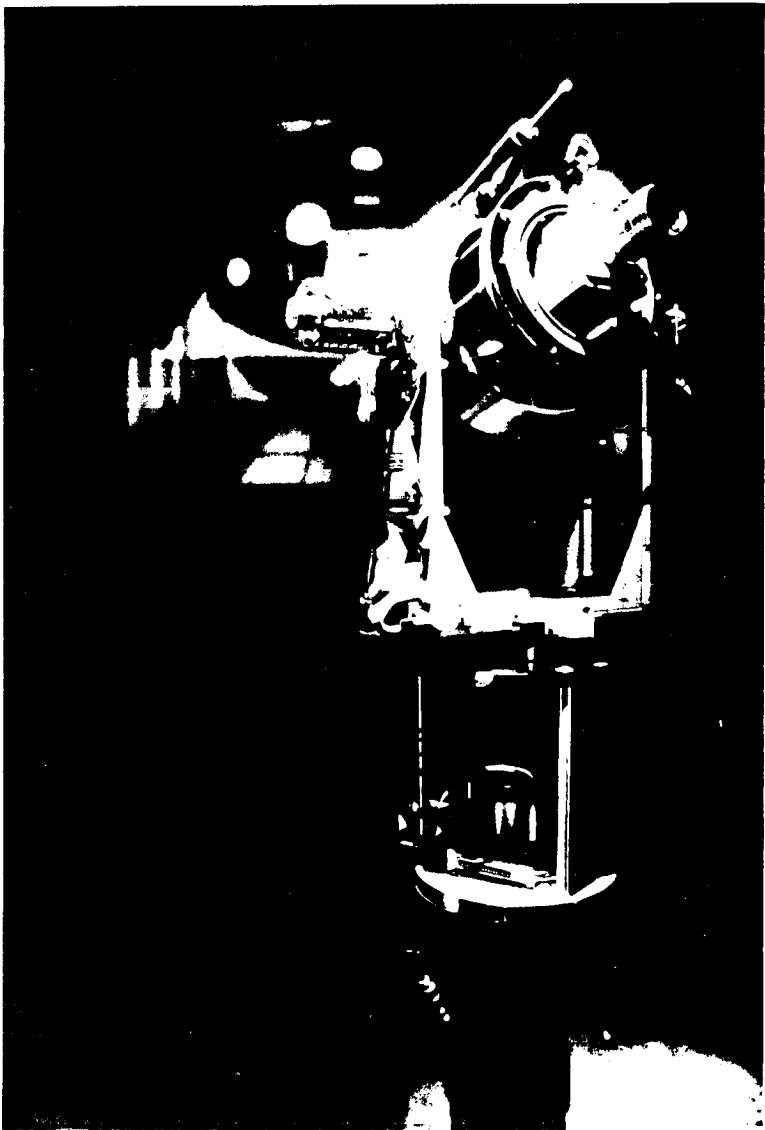

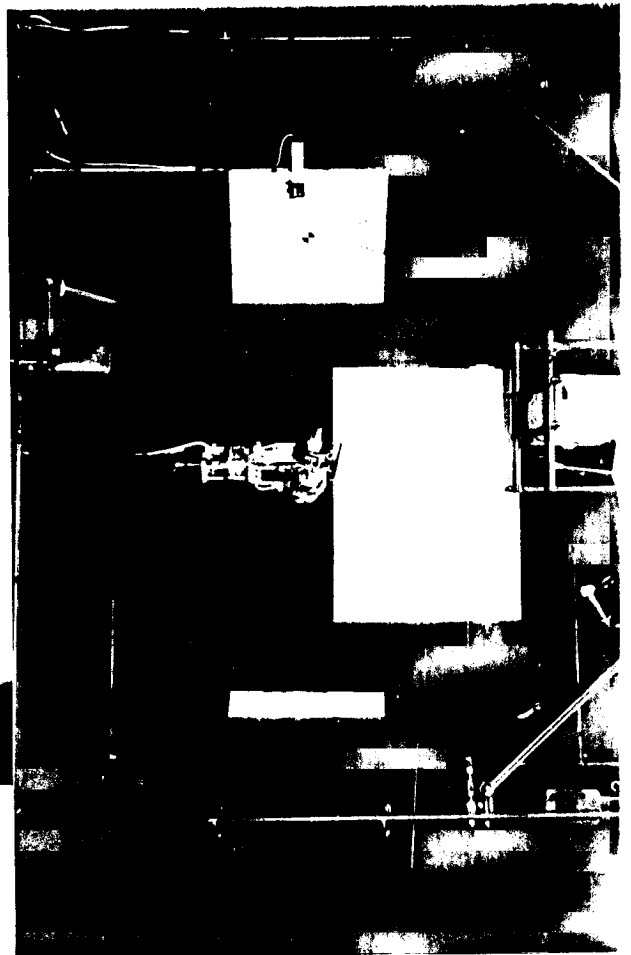
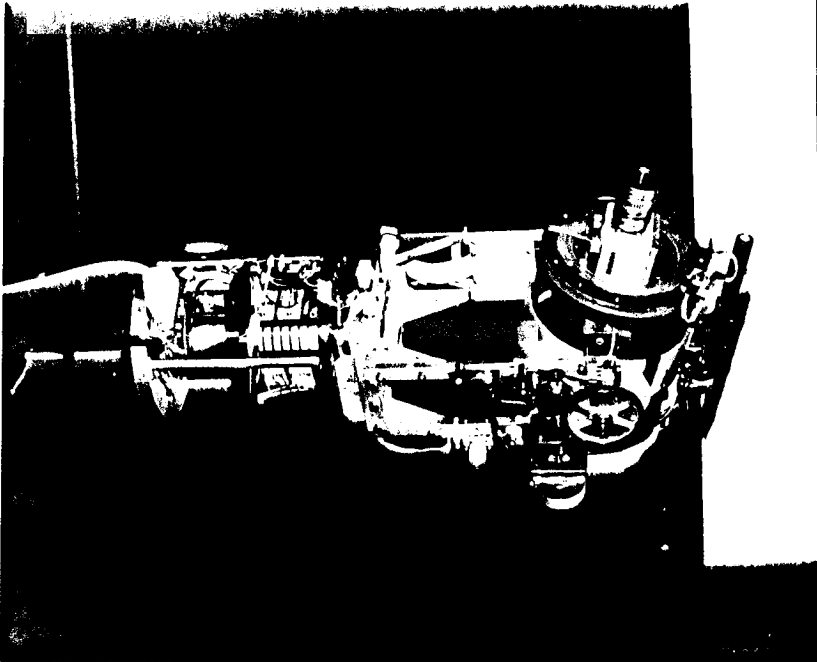
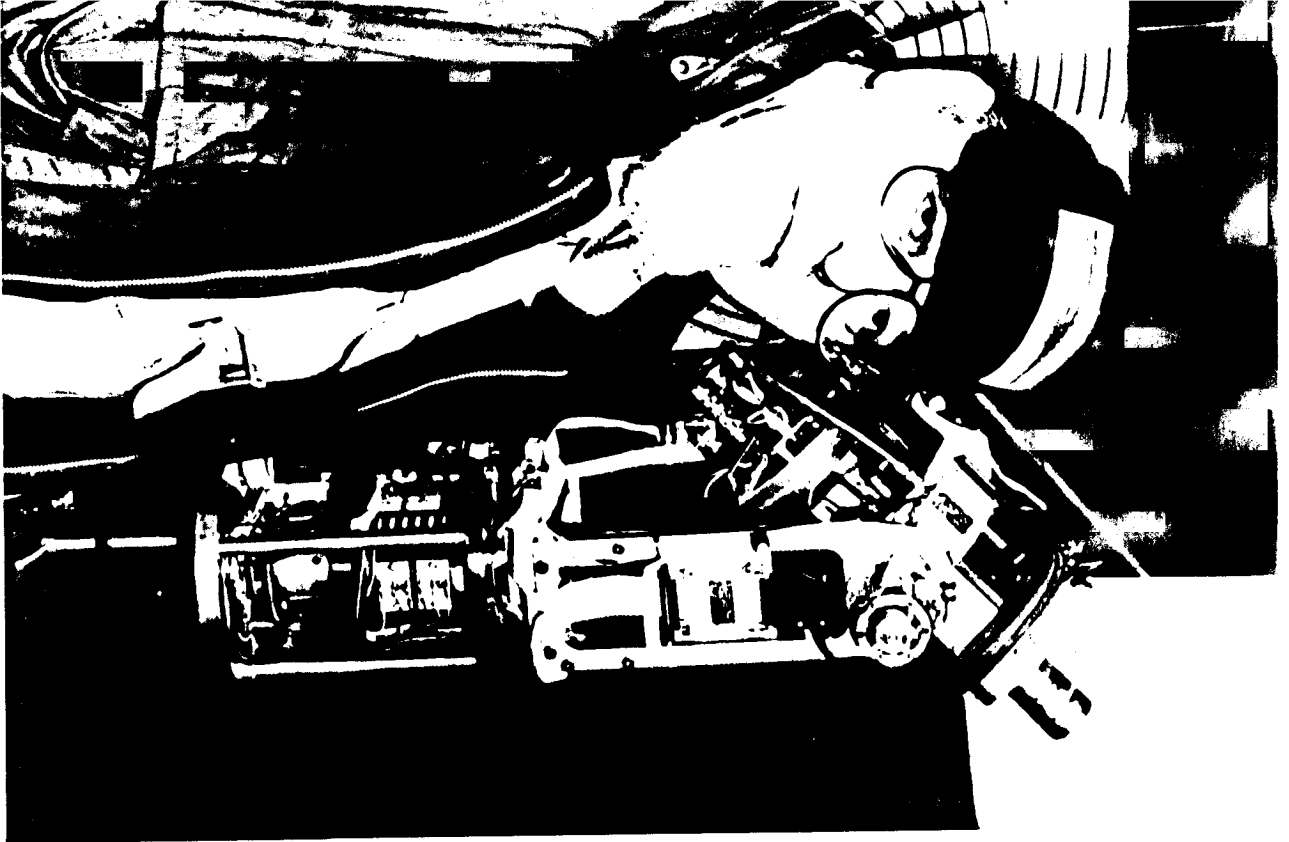

*THEATER OF HYBRID
AUTOMATA*

THE VASULKAS INC.
471-7181 FAX: 473-0614
ROUTE 6 BOX 100
SANTA FE NM 87501

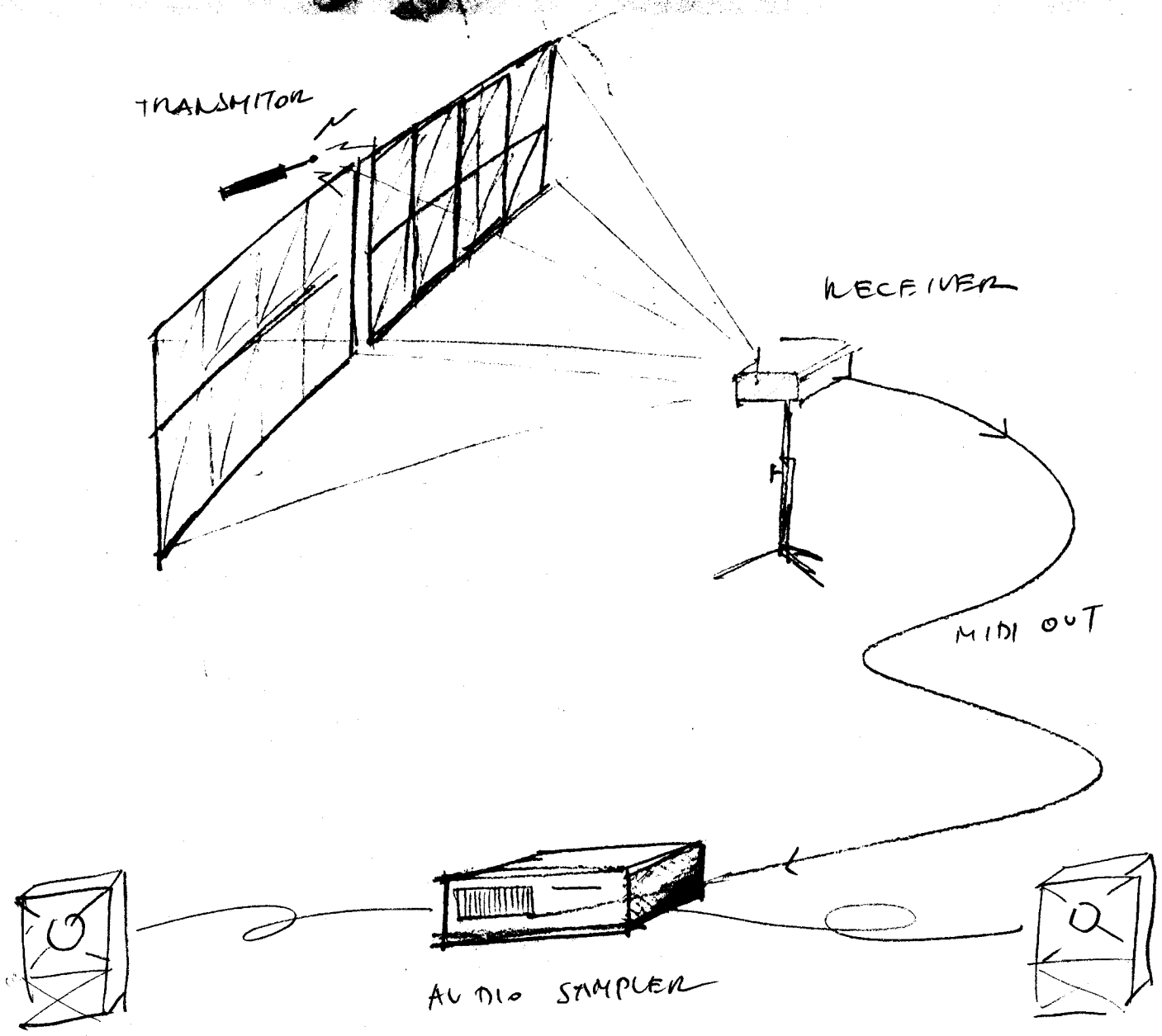

HYBRID AUTOMATA (BUCKLA - LIGHTNING MIDI
MUSICAL INSTRUMENT)

THE VASULKAS INC.
471-7181 FAX: 473-0814
ROUTE 6 BOX 100
SANTA FE NM 87501

INSTRUMENTATION STAND (DIMENSIONS)

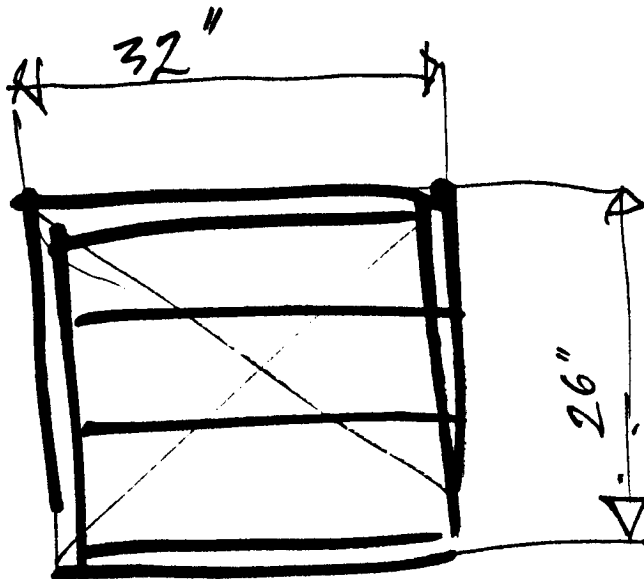
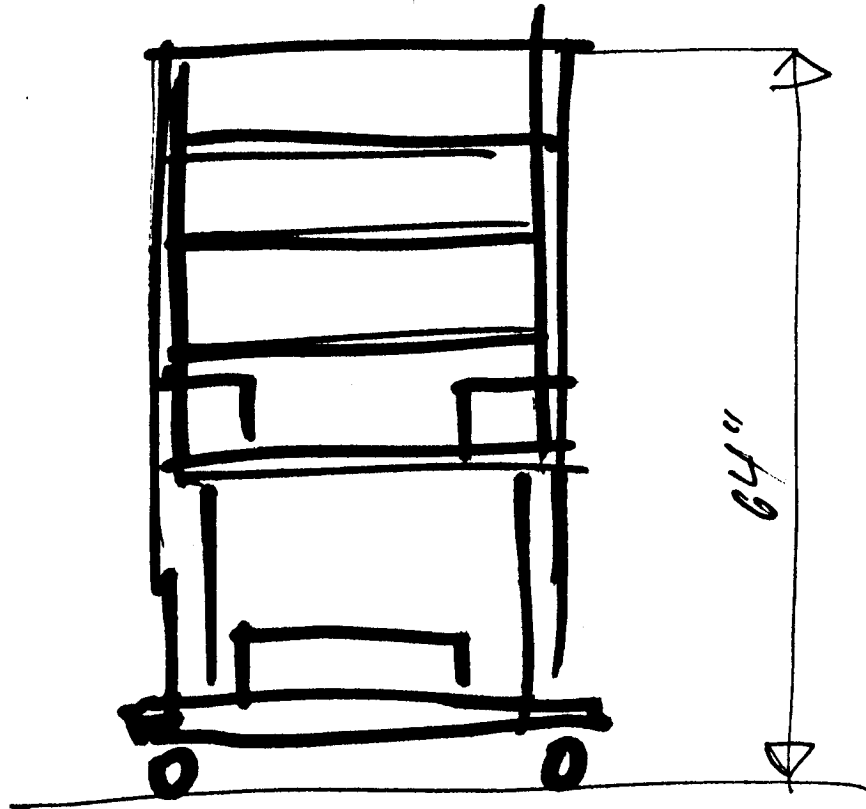

INSTRUMENTATION STAND

FRONT

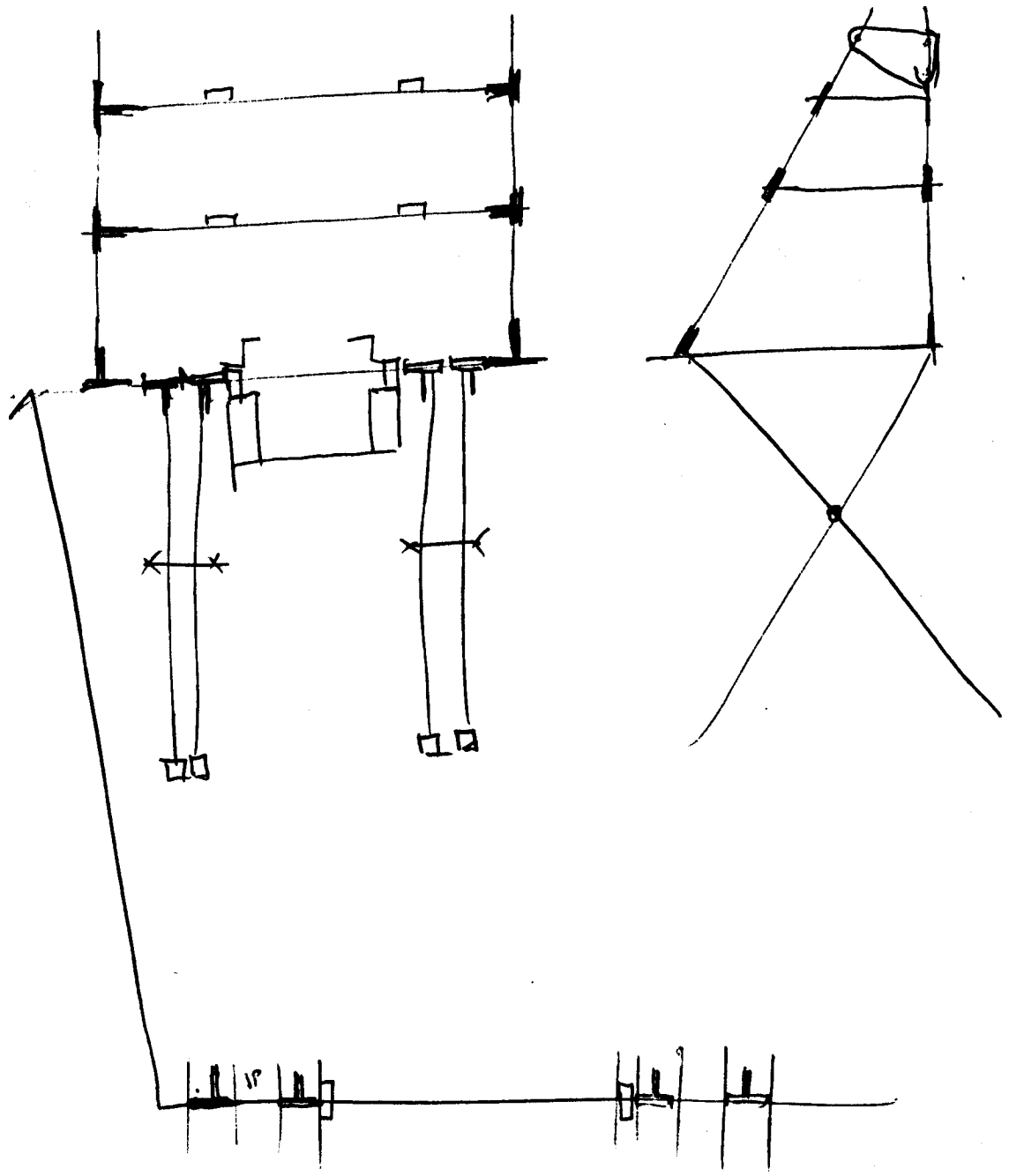

Vasuka

plan
scale: 1/500

TREATER OF
HYBRID
AVTOHKTA

cathe - ceiling structure
black fabrica (velum)

alignment of handrail
wood

plancher 0.17 m

atelier philippe d'elie
14 73 rue Weber
83103 montreal
tel 46 70 17 85
fax 46 70 16 74

Artifices 2

10. AUCIEN 7.65m

ROUTE 6 BOX 100
SANTA FE NM 87501

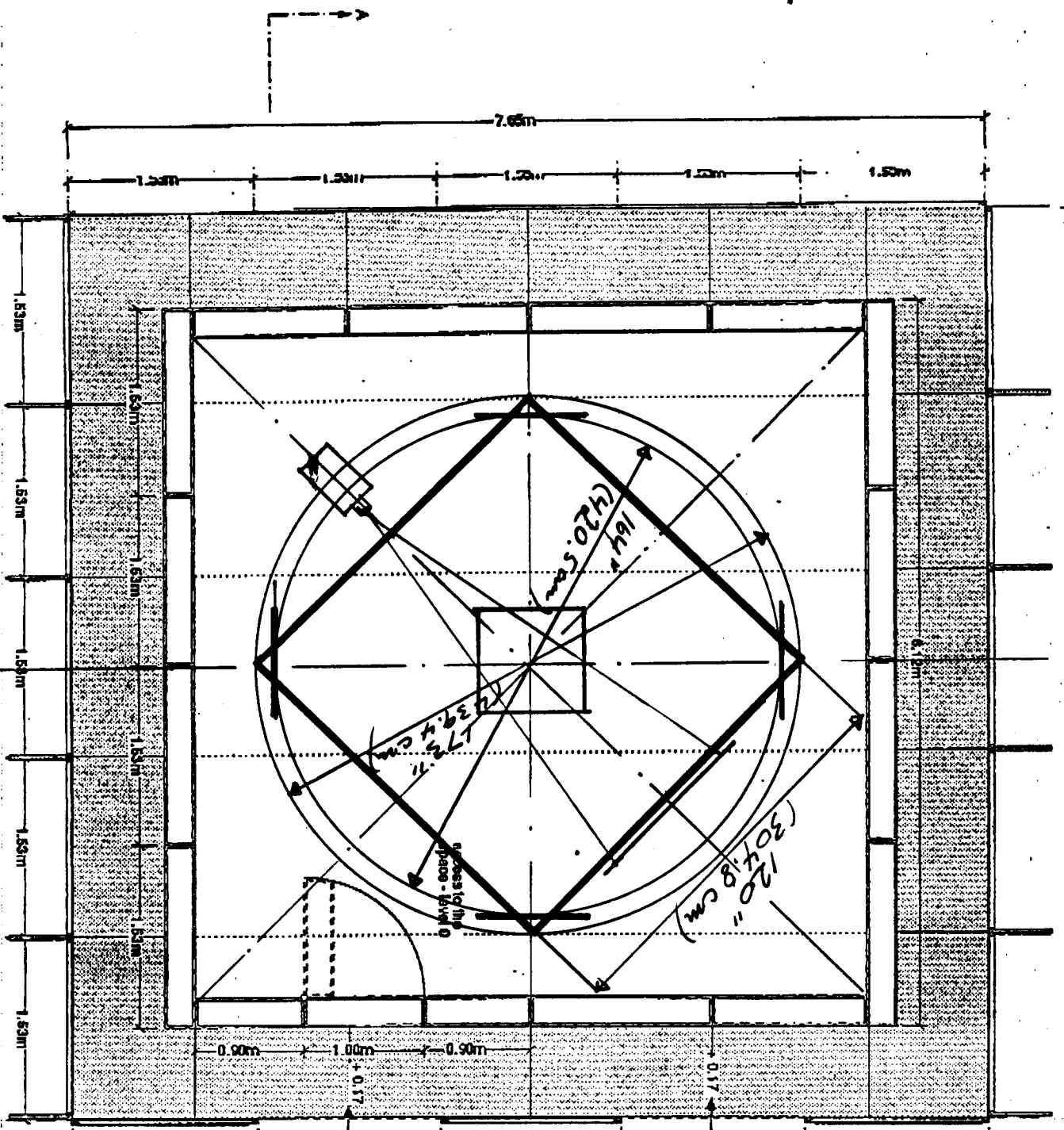

entrance 1

entrance 2

Wark

Vasulka

Cross section AA'
Scale: 1/50

THEATER OF HYBRID
AVTOHTATP

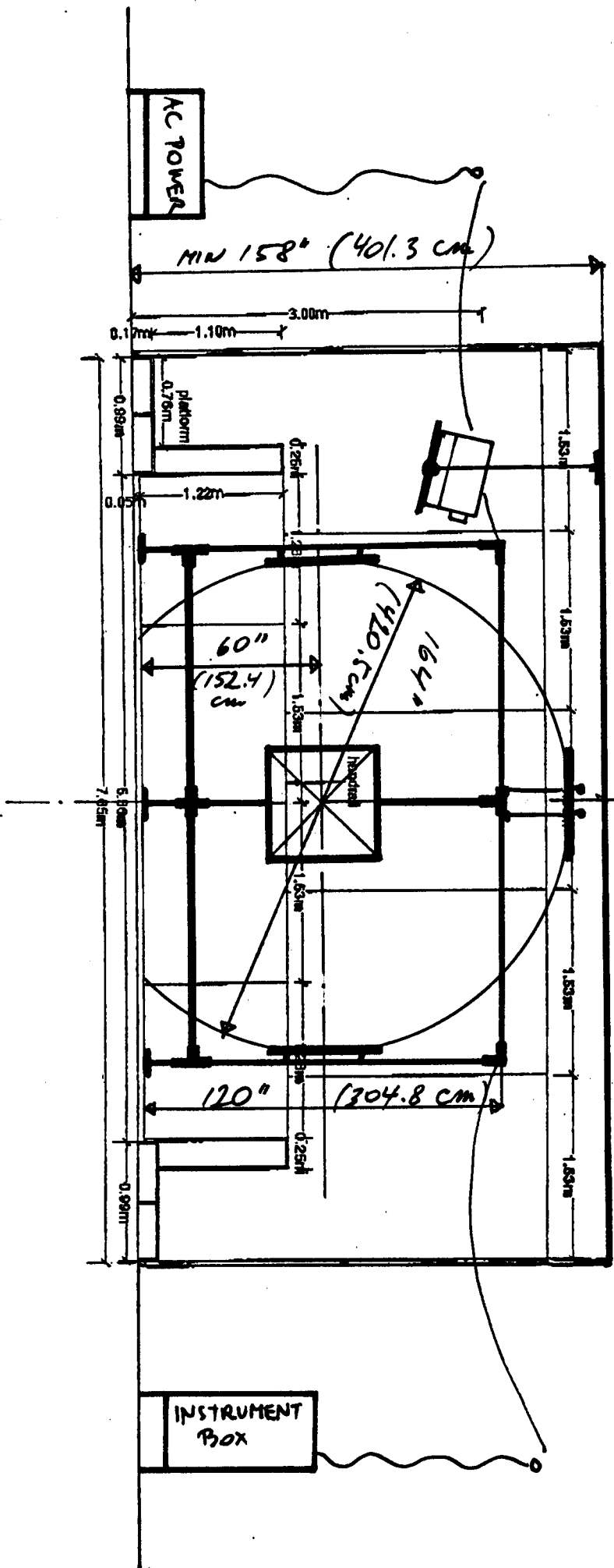

THE VASULKAS INC.
471-7181 FAX: 473-0614
ROUTE 6 BOX 100
SANTA FE NM 87501

F&VU
VIDEO
MULTIMEDIA
PERFORMANCE
WOODY VAŠULKA

JUNE 12-94
W.

CAMERA HEAD VIDEO
SYNCHRONIZES TSC

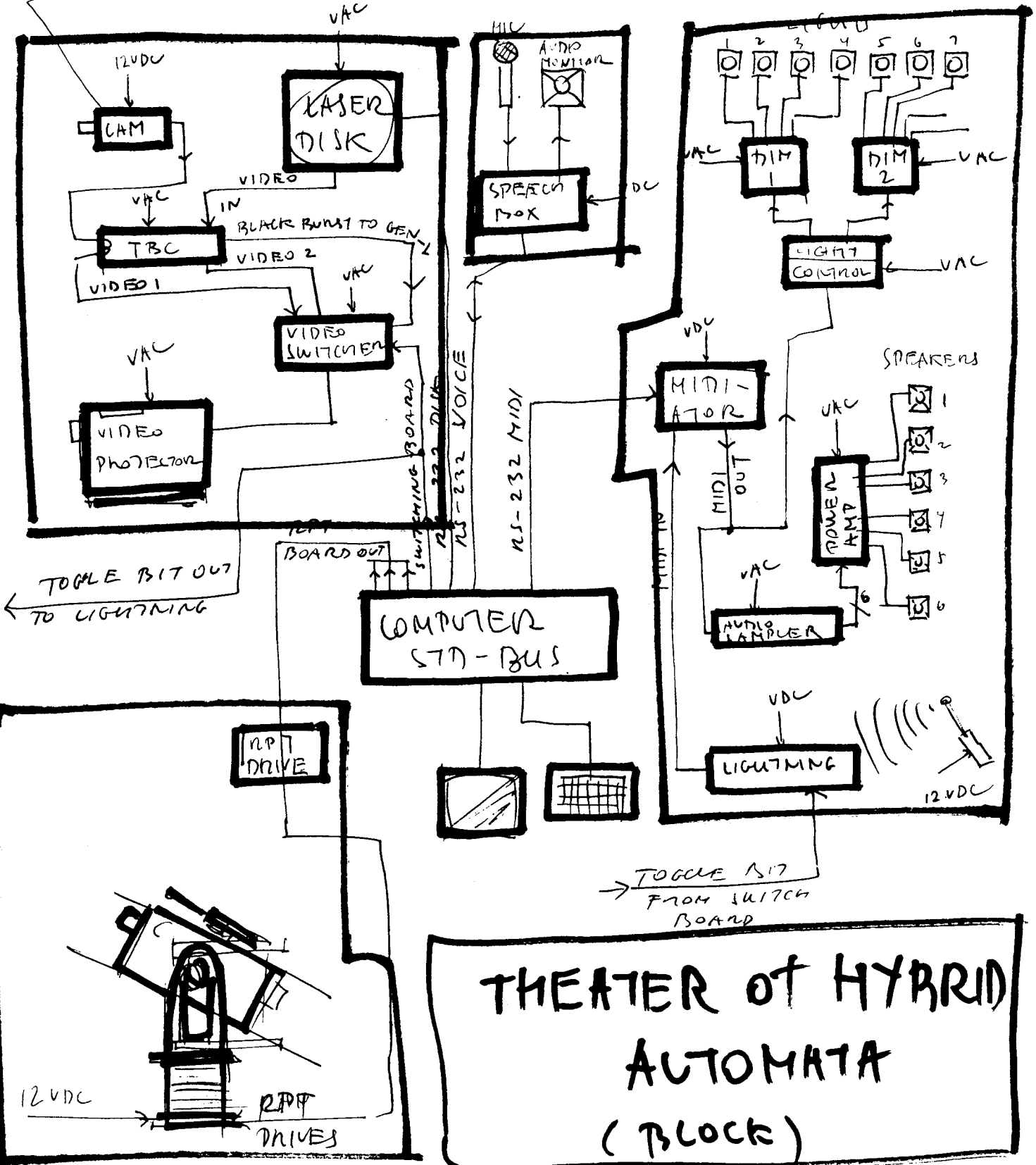

**THEATER OF HYBRID
 AUTOMATA
 (BLOCK)**

Vesulka

plan
scale: 1/500

THEATER OF
HYBRID
AUTOMATA

.....
cotton - ceiling structure
black fabric (velvet)

□
alignment of wooden
wood

▨
pitched 8.17 m

Offices 2

atelier philippe dille
14 / 13 rue Alder
63103 montaut
tel 46 70 17 05
fax 46 70 18 74

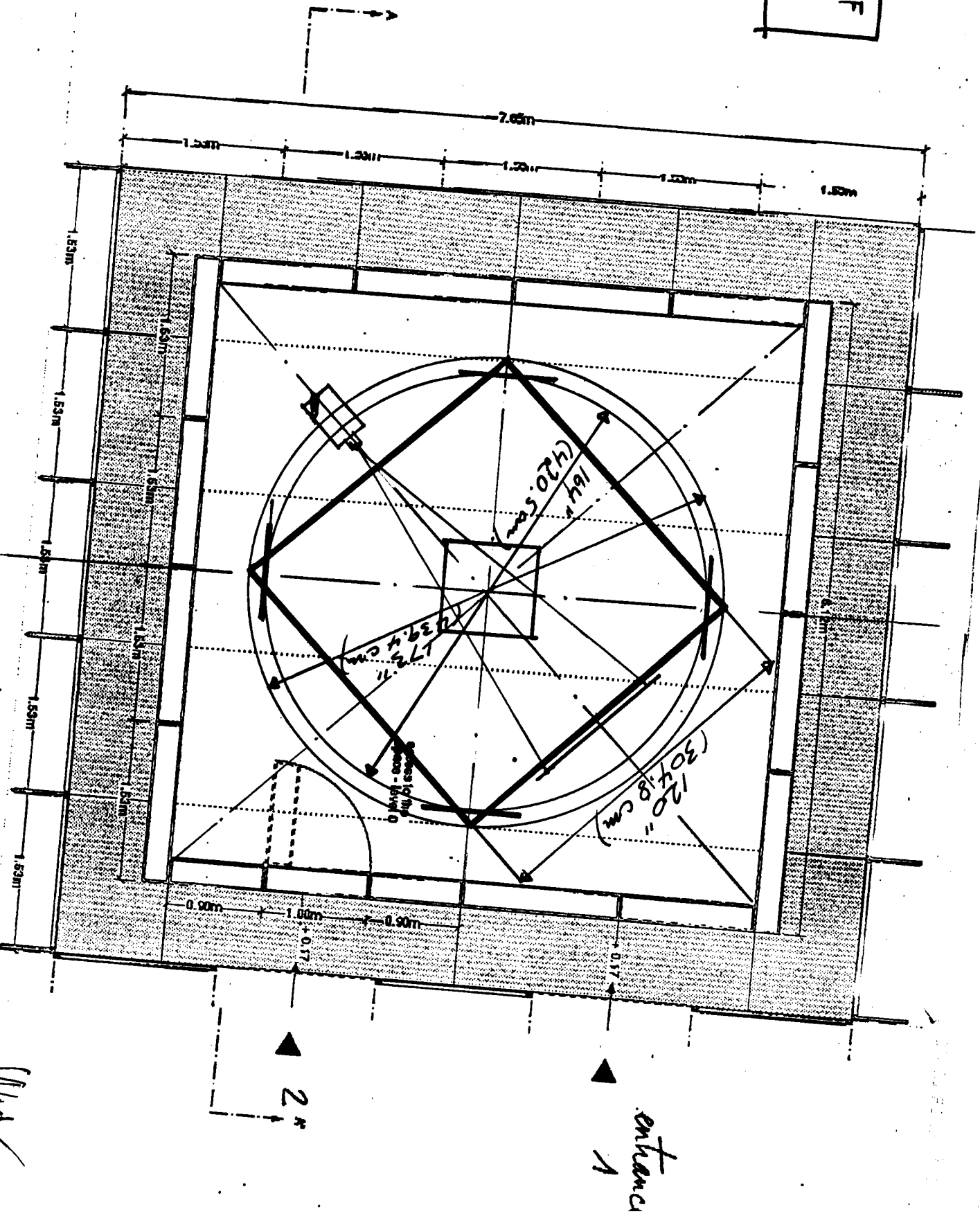

Ward

Vasulika

cross section AA
scale : 1/50°

THEATER OF HYBRID
AUTOMATA

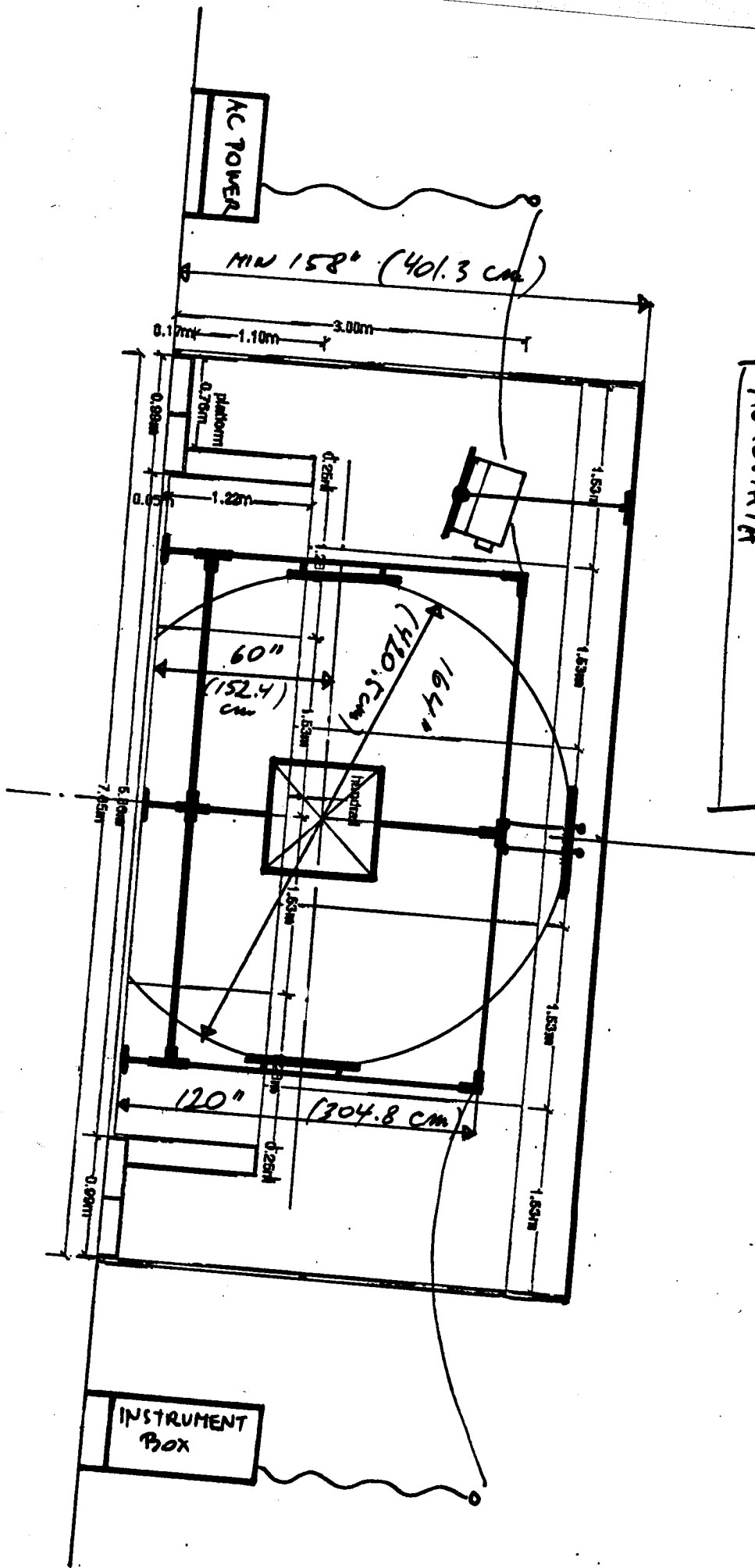

THE VASULKAS INC.
471-7181 FAX: 473-0614
ROUTE 6 BOX 100
SANTA FE NH 87501

your tubular structure

ARTIFICES 2

plan
échelle 1/100°

*AC power line
wall ≈ 3 meters high*



schéma général de l'alimentation électrique
 ———— gaine de protection alimentation
 - - - - - alimentation sous plancher

- bloc autonome
- R.I.A.
- éclairage ambiant

your tubular structure

ARTIFICES 2

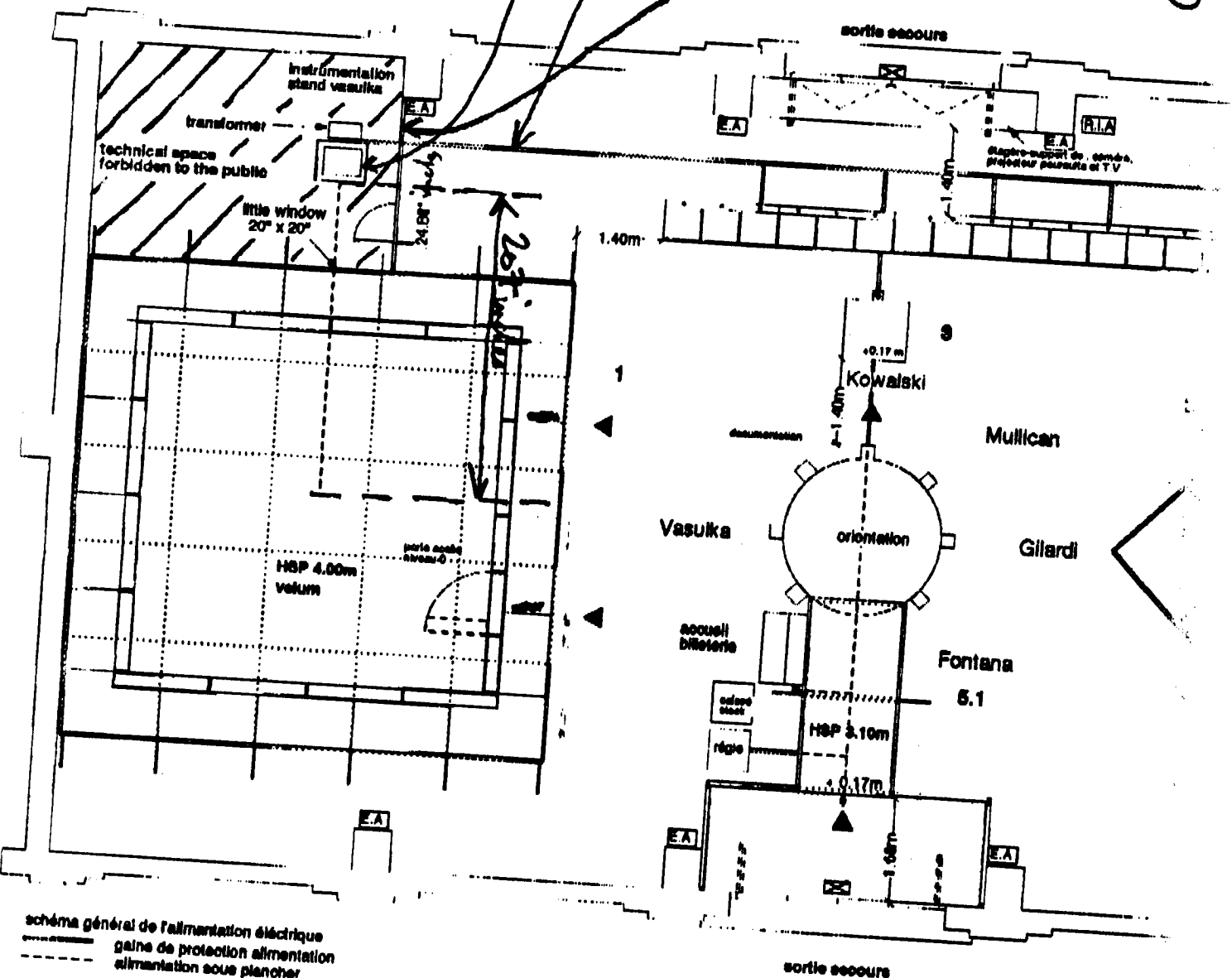
plan
échelle 1/100°

*AC power line
wall ≈ 3 meters high*



schéma général de l'alimentation électrique
 - - - - - gaine de protection alimentation
 - - - - - alimentation sous plancher

-  Boc autonome
-  RIA
-  éclairage ambiant

THE VASULKAS INC.
 471-7181 FAX: 473-0614
 ROUTE 6 BOX 100
 SANTA FE NM 87501

Yasujika

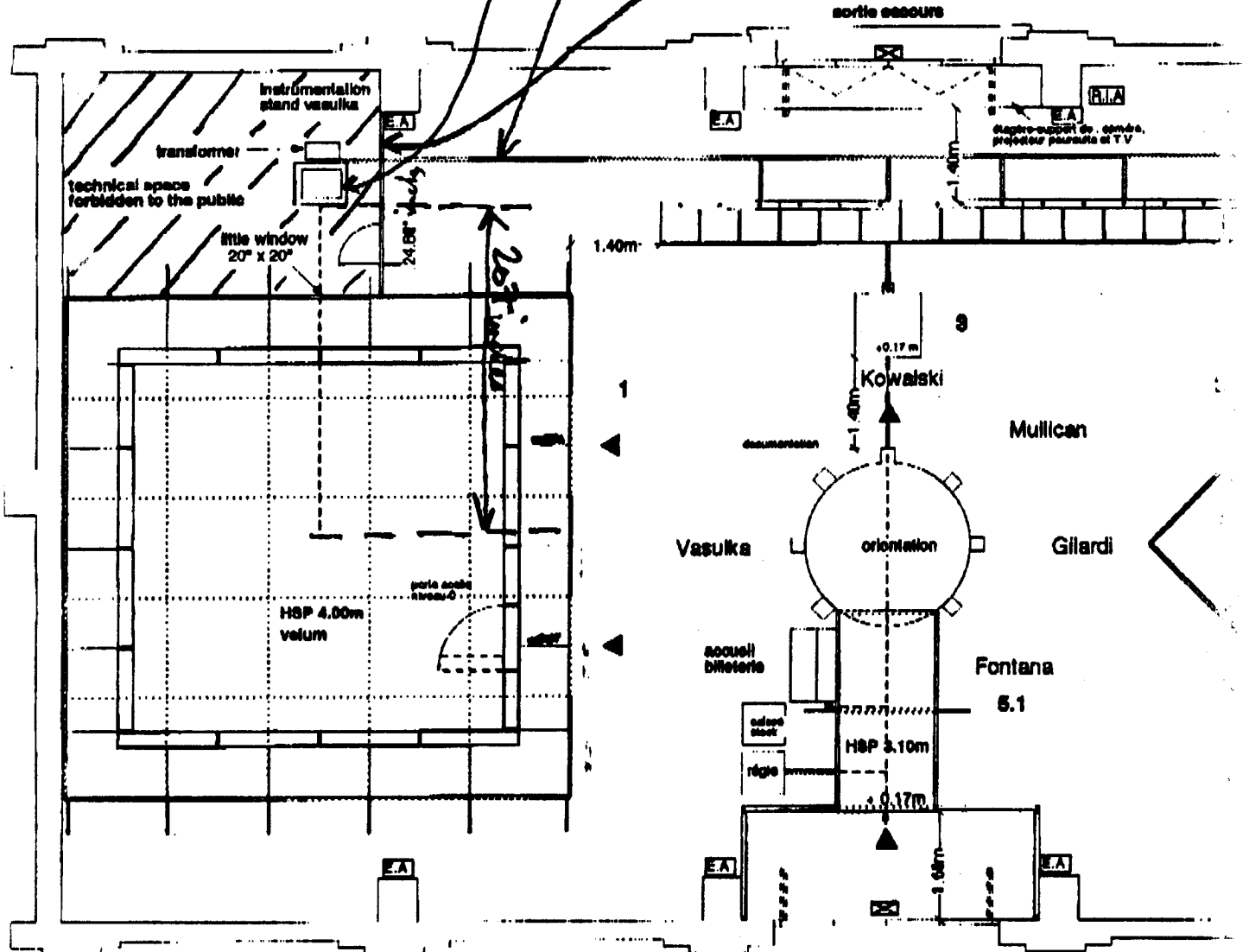
plan
scale: 1/500

TREATED OF
HYBRID
AUTOMATA

... ..
cathode - ceiling structure
Black fabric (Yelium)



alignment of handrail
wood



platform 0.17 m

Artifices 2

atelier philippe olliva
14/73 rue Wilber
63103 montreal
tel 46 70 17 85
fax 46 70 18 74

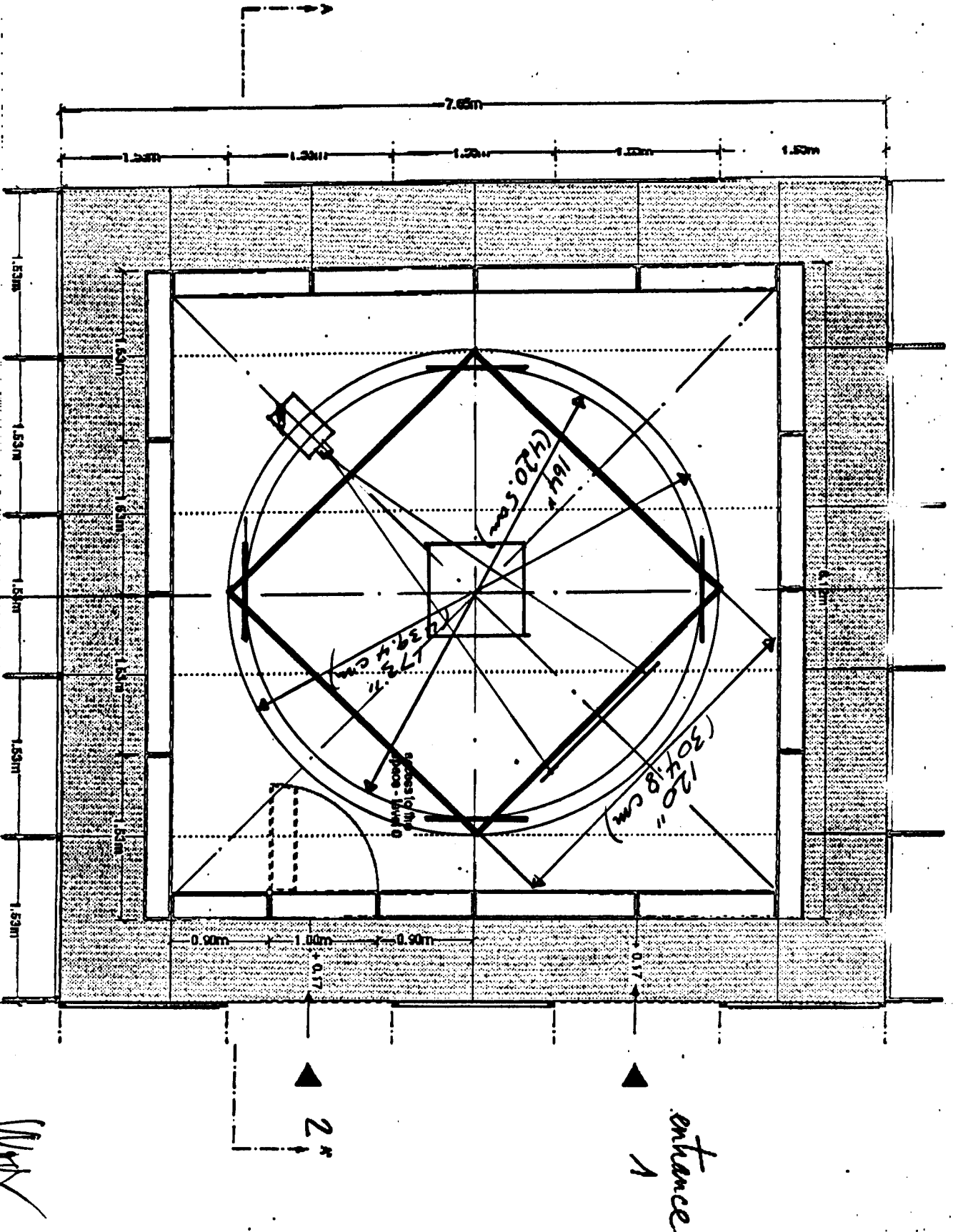

Mindy

Vasuka

plan
scale : 1/50°

.....
cathe - ceiling structure
black lacina (Polina)



element of handrail
wood



perimeter 0.17 m

Artifices 2

atelier philippe d'alle
14 rue de l'hor
93103 Montreuil
tel 46 70 17 86
fax 46 70 18 74

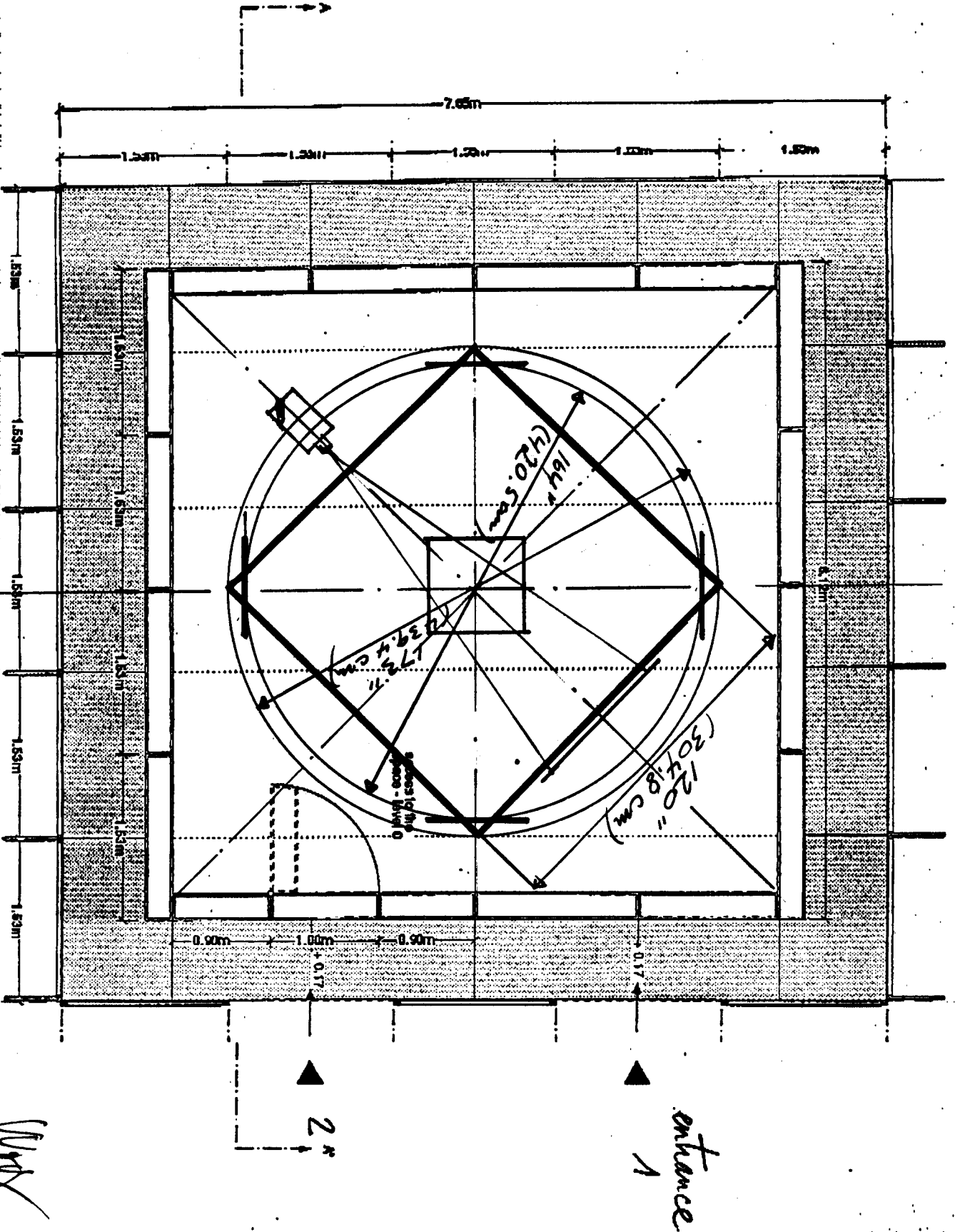

Vasulika

cross section AA'
scale : 1/50'

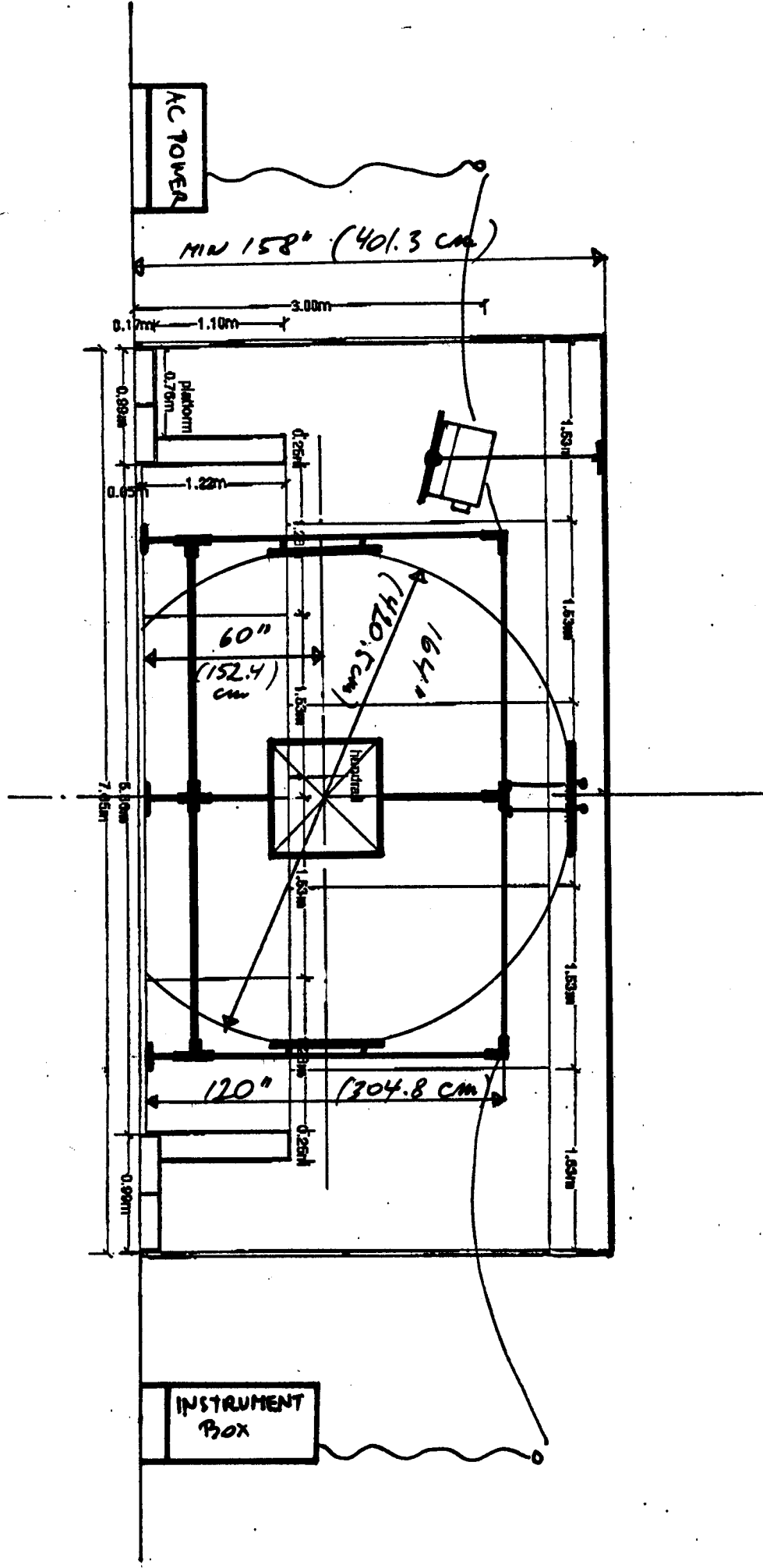

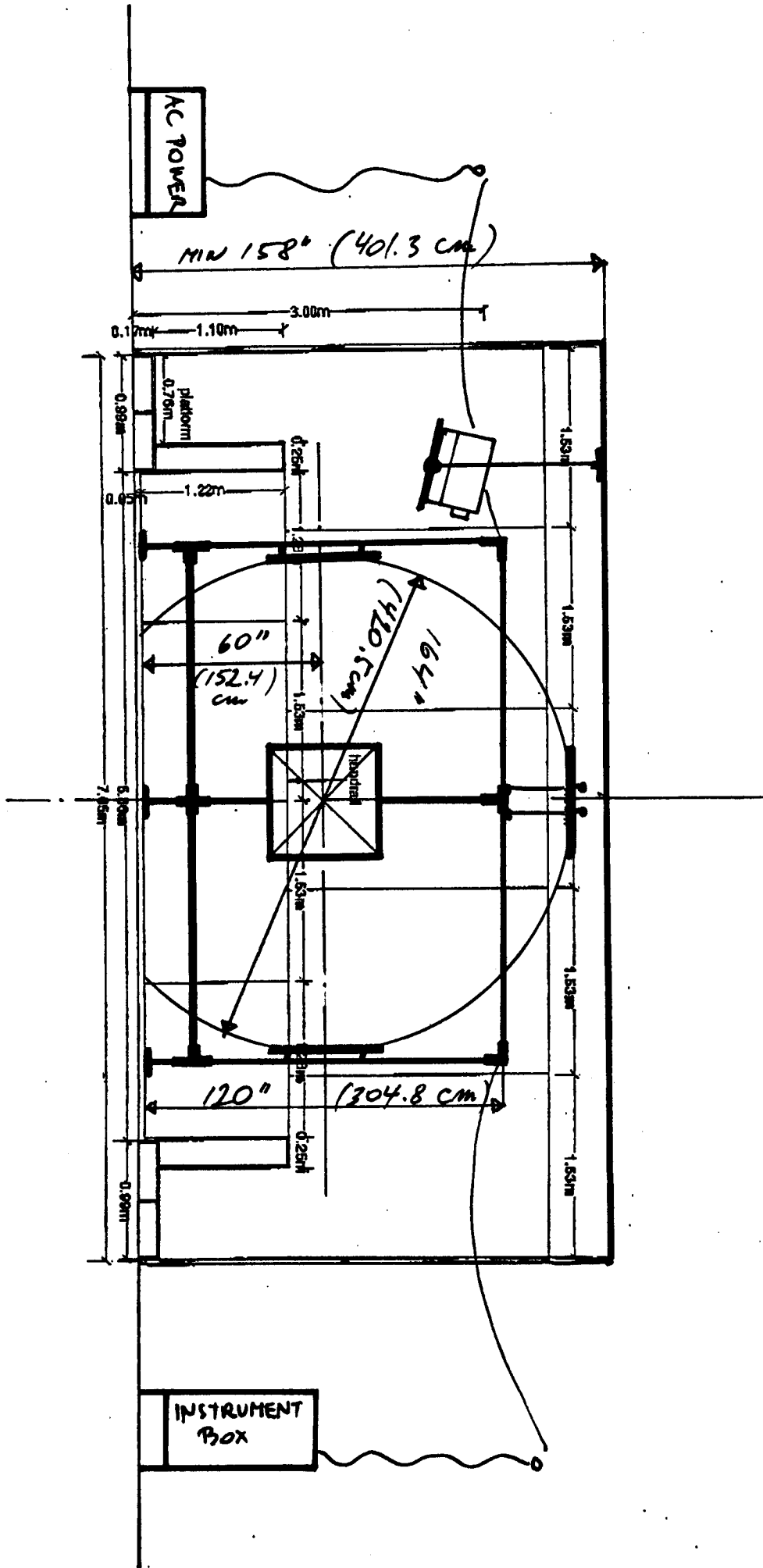

Vasulika

Cross section AA
 scale : 1/50°

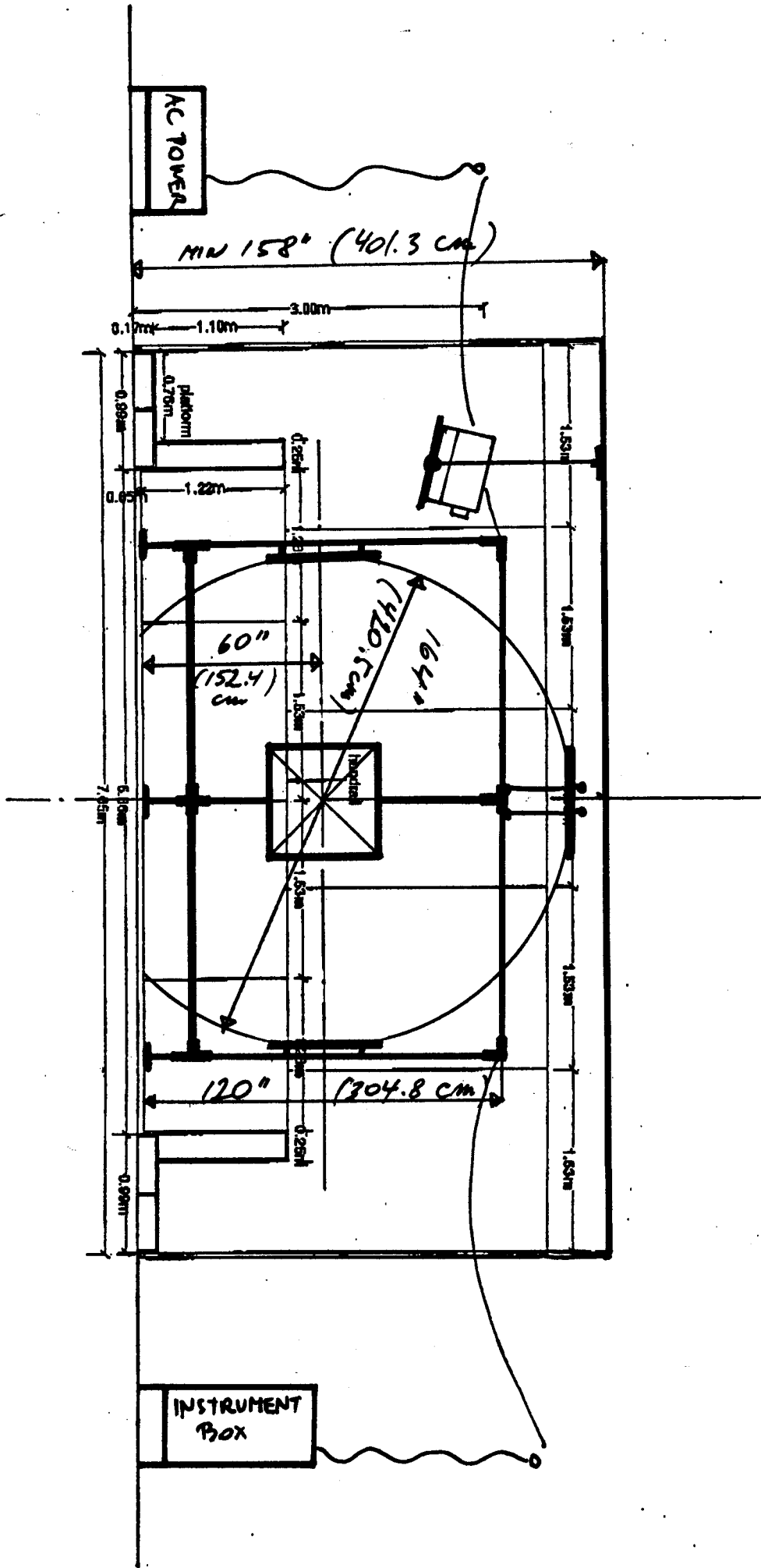

SFMOMA

MACHINE MEDIA:
Steina and Woody Vasulka
February 2- March 31, 1995

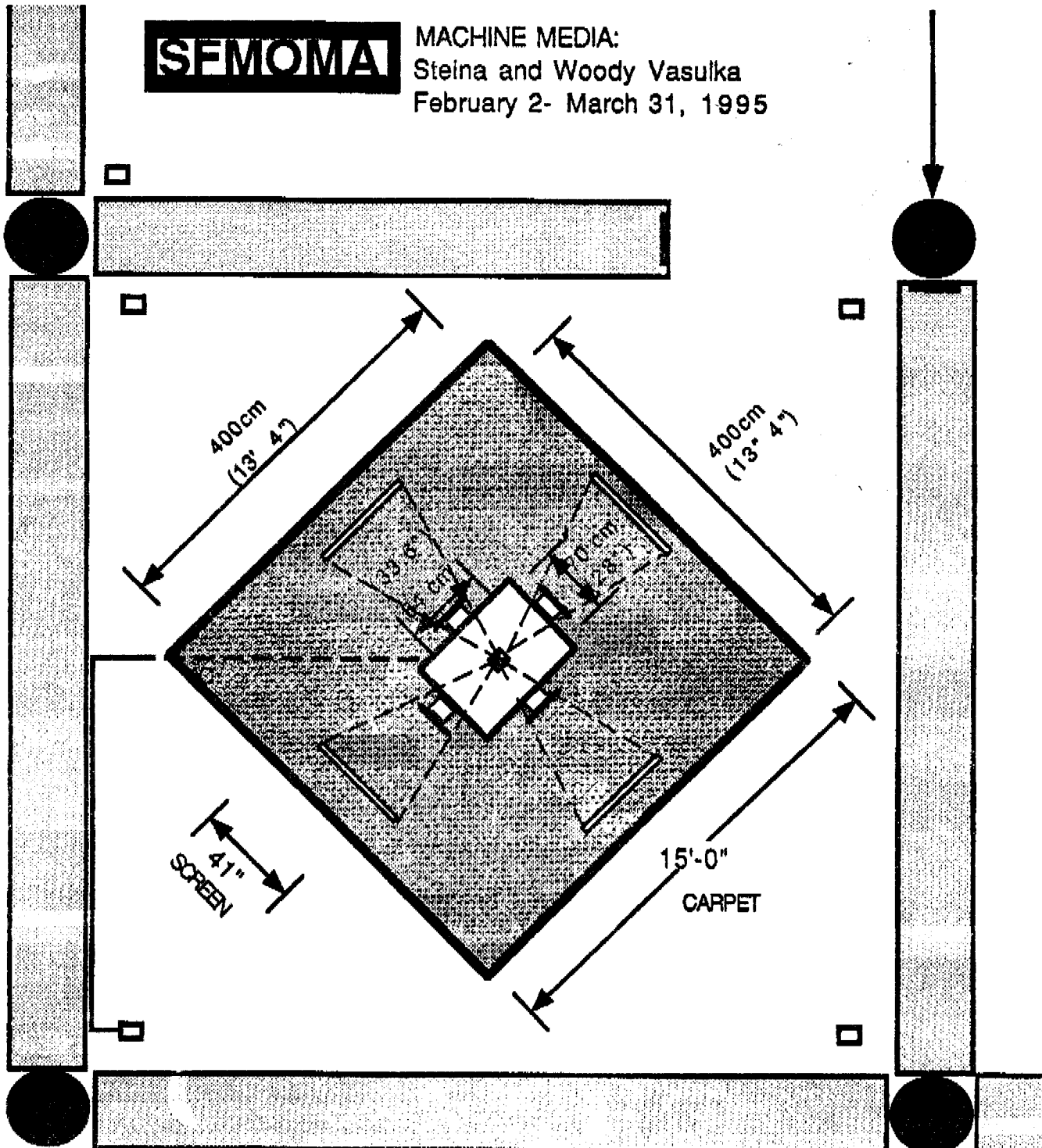

GALLERY PAINTED LONDON GRAY
FULLER O'BRIEN H87

THE BROTHERHOOD TABLE III

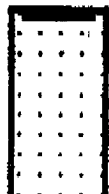

SFMOMA 4th Floor South Detail (F) SCALE 1"= 5'

PREPARED 11/95 BY J. GRAHAM

UPDATED 12/5/95

your tubular structure

ARTIFICES 2

plan
échelle 1/100°

*AC power line
wall ≈ 3 meters high.*



schéma général de l'alimentation électrique
 - - - - - gaine de protection alimentation
 - - - - - alimentation sous plancher

- bloc autonome
- RIA
- éclairage ambiant

THE VASULKAS INC.
 471-7181 FAX: 473-0614
 ROUTE 6 BOX 100
 SANTA FE NM 87501

Vasulka

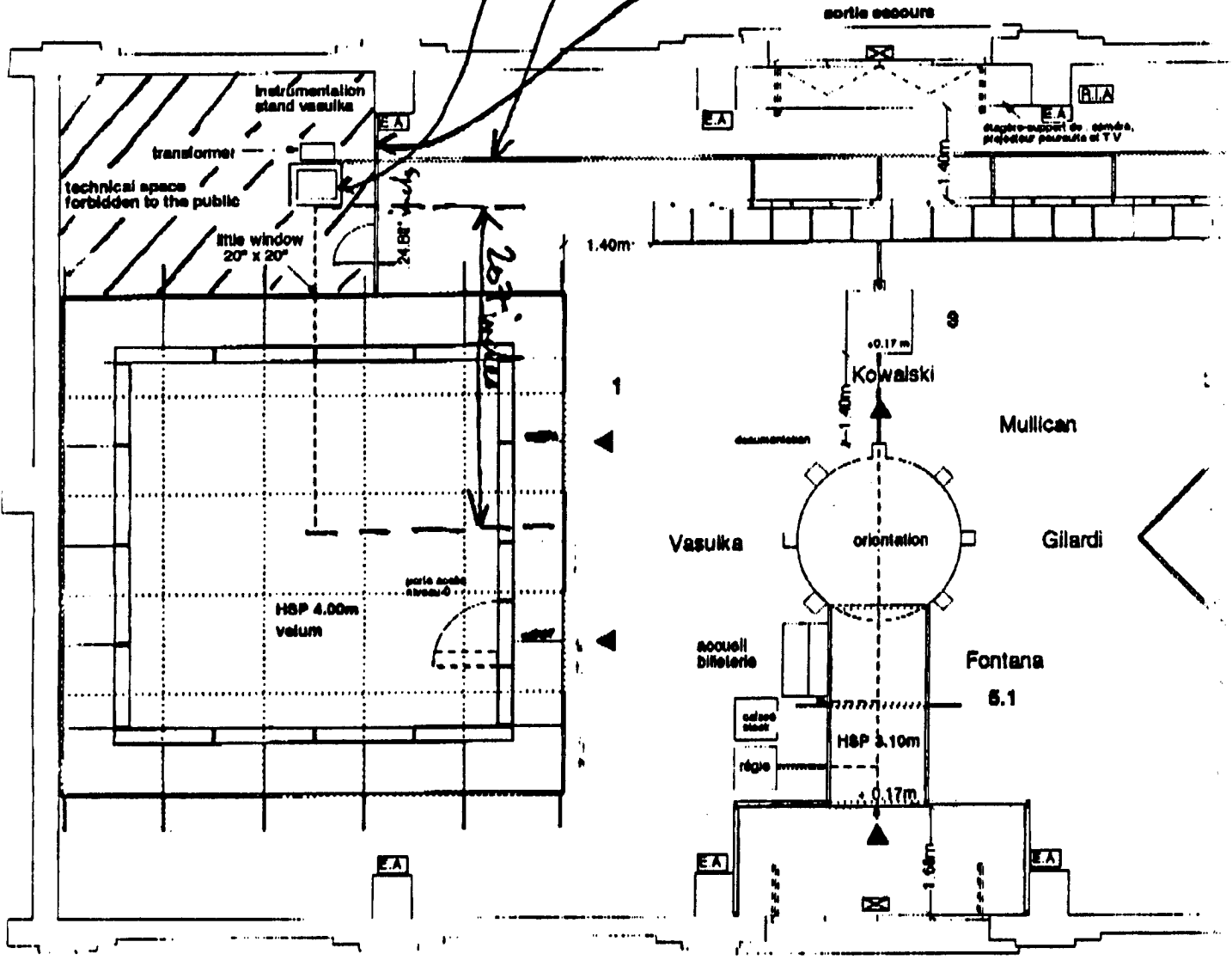
plan
scale: 1/500

THEATER OF
HYBRID
AVTOMATA

catches - sitting structure
black fabrica (yellow)

diameter of handrest
wood

pedimental 0.17 m

Artifices 2

atelier philippe d'alle
14/13 rue du boer
83103 rochepoard
tel: 49 70 17 85
fax: 49 70 18 74

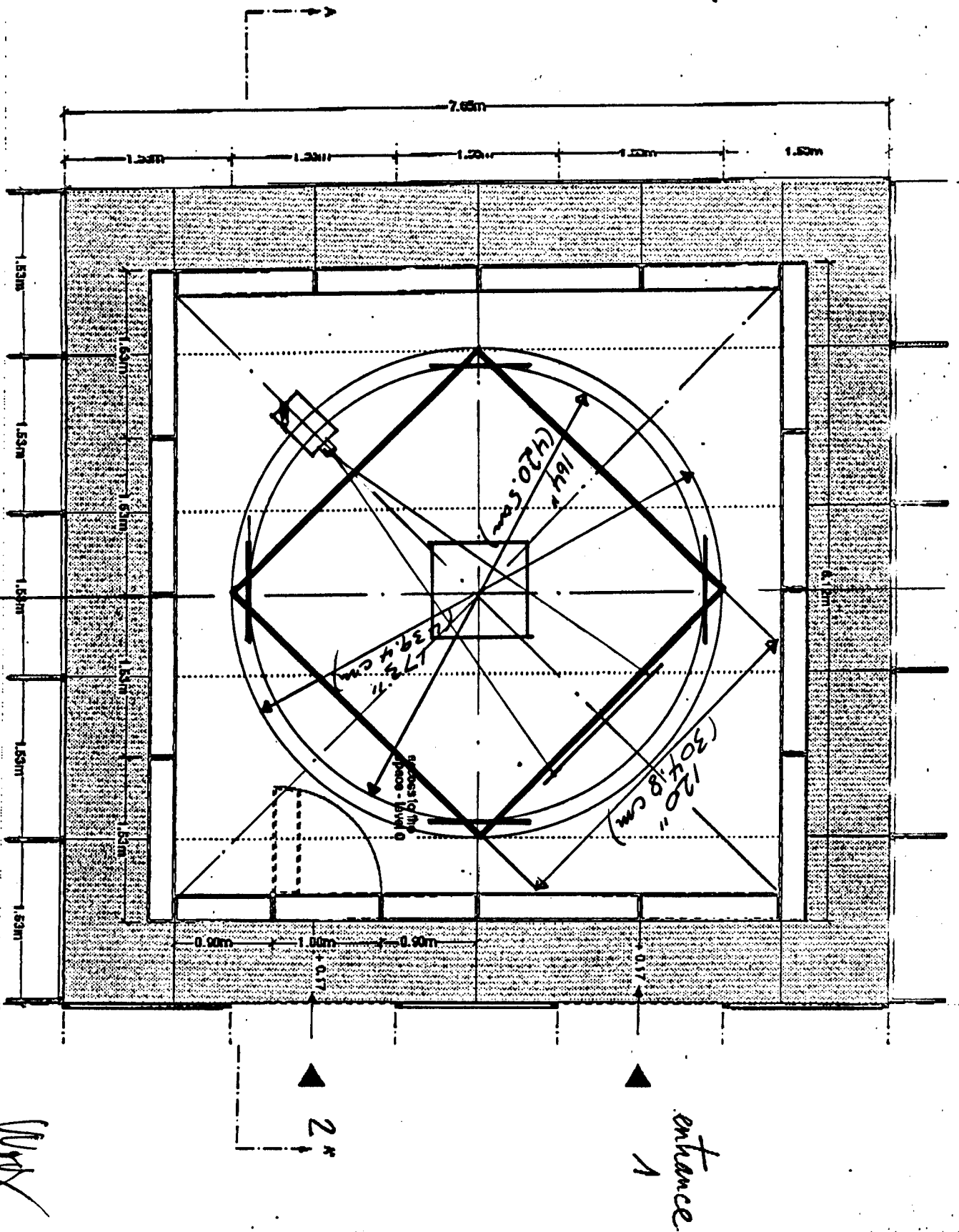

Windy

cross section AA'
scale: 1/50

Vasulika

THEATER OF HYBRID
АУТОМАТИЗАЦИЯ

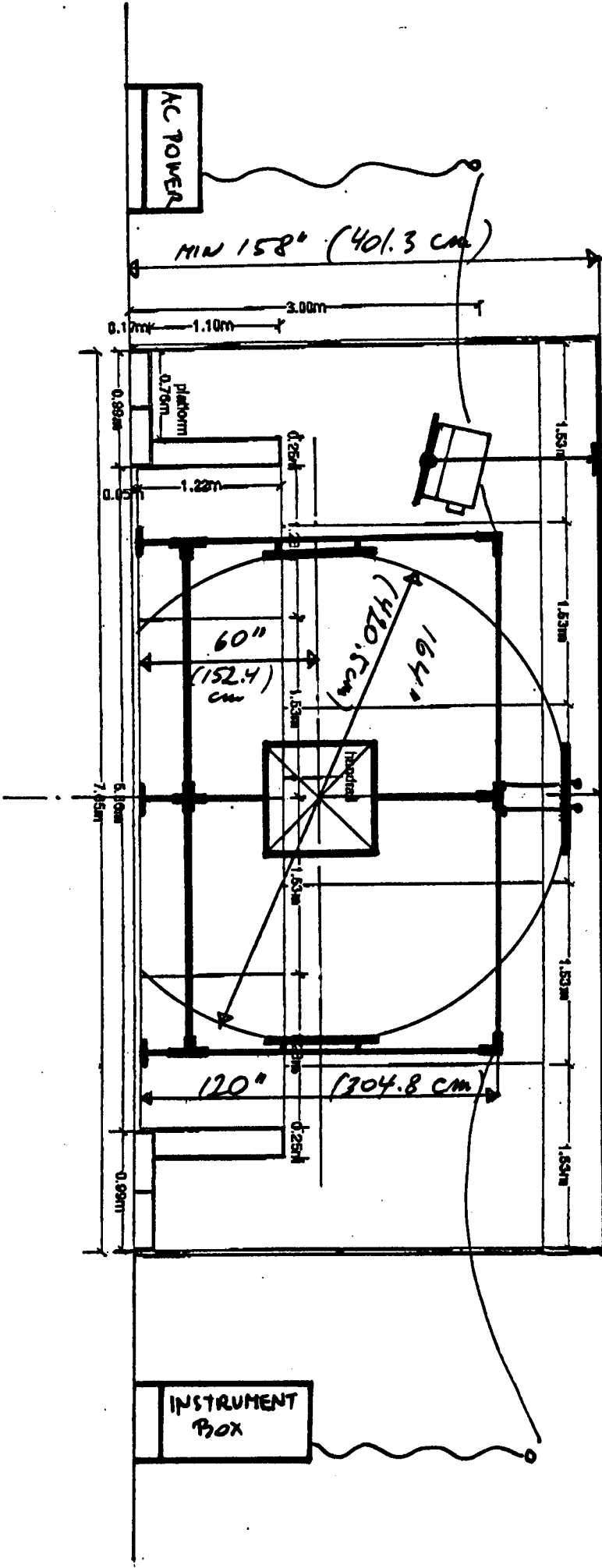

THE VASULKAS INC.
471-7181 FAX: 473-0614
ROUTE 6 BOX 100
SANTA FE NM 87501

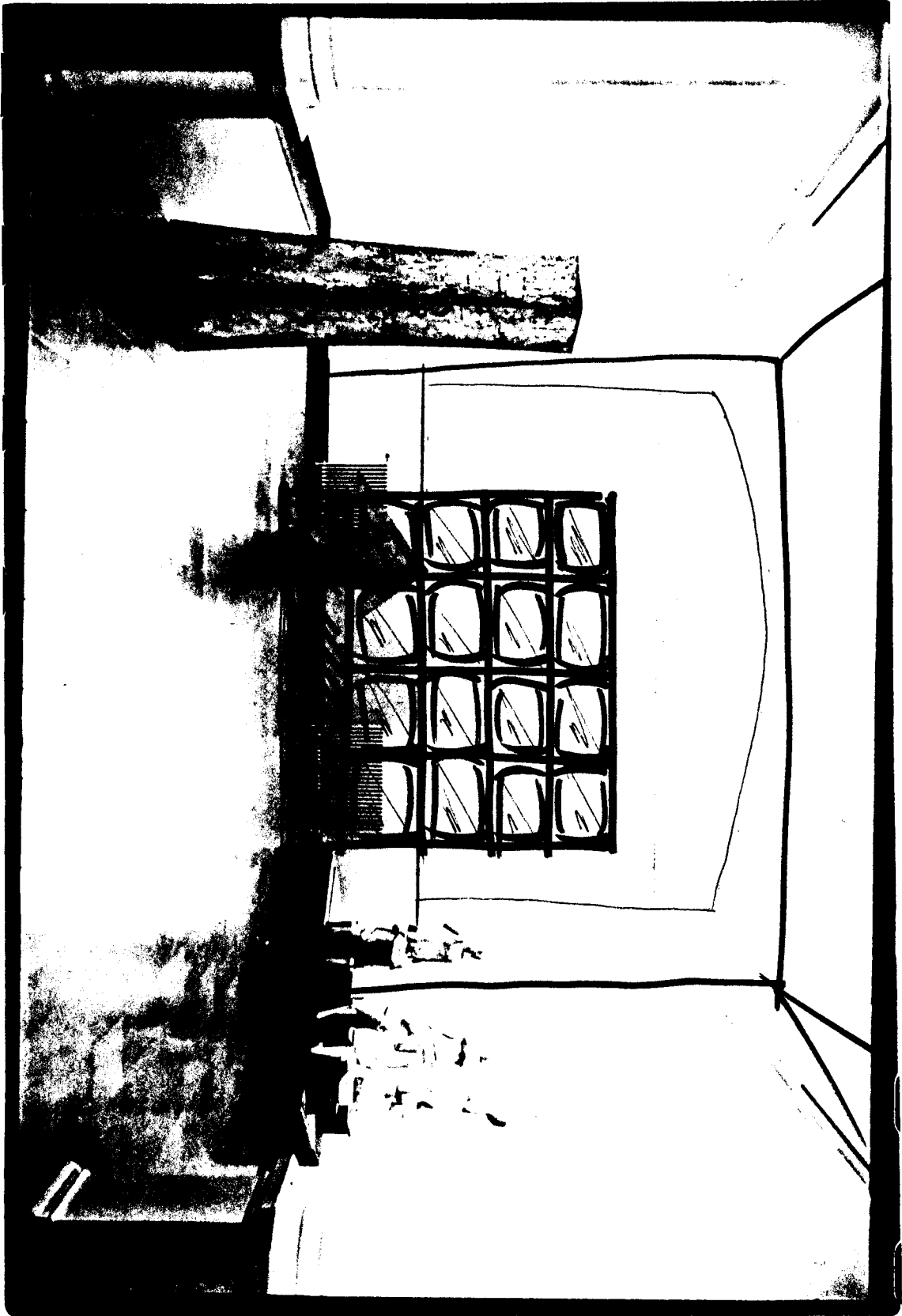

ONE
REVOLUTION

CYCLE
STEP

